

PLANTING GUIDE

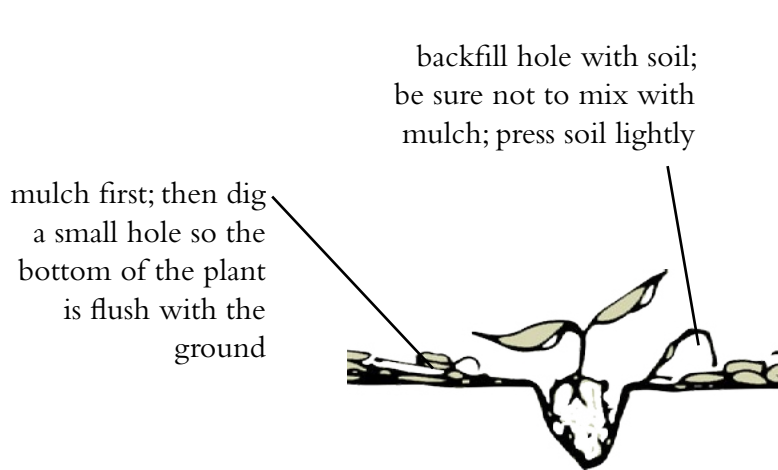

small circular wall around the base of the plant; this will help keep water in place for absorption

hole should be the same height as the root ball and about double the width

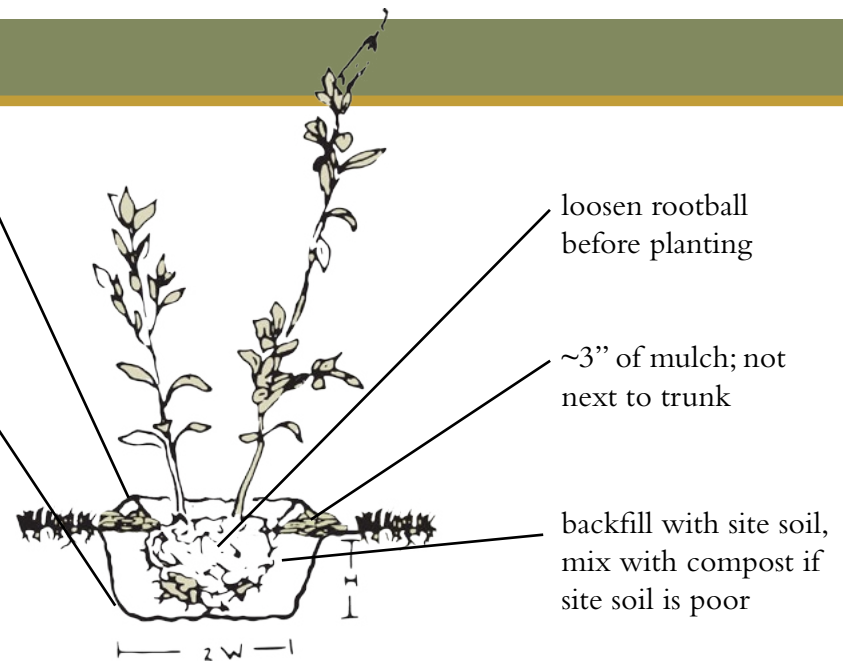

★ WATER PLANTS THOROUGHLY AFTER PLANTING ★

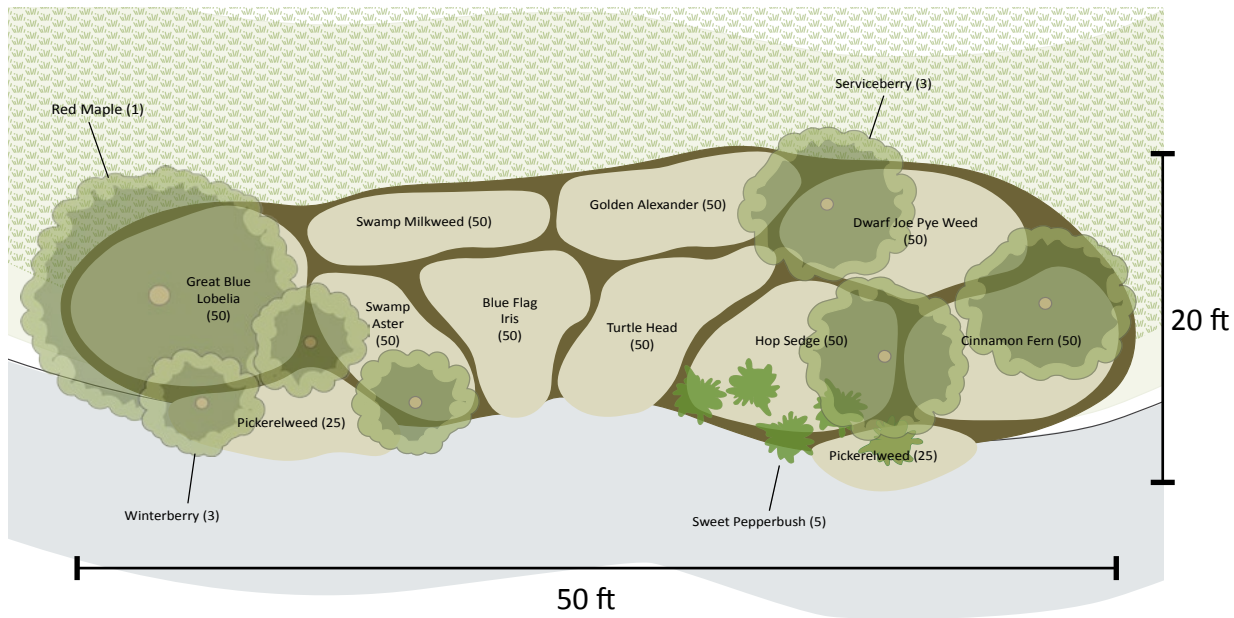

Shrubs/Trees

- 1 Red maple
- 3 Serviceberry
- 5 Sweet pepperbush
- 3 Winterberry

Herbaceous

- 1 50-cell flat Pickerelweed
- 1 50-cell flat Cinnamon Fern
- 1 50-cell flat Hop Sedge
- 1 50-cell flat Turtle Head
- 1 50-cell flat Dwarf Joe Pye weed
- 1 50-cell flat Swamp Aster
- 1 50-cell flat Blue Flag Iris
- 1 50-cell flat Swamp Milkweed
- 1 50-cell flat Great Blue Lobelia
- 1 50-cell flat Golden Alexander

PLANT SPACING

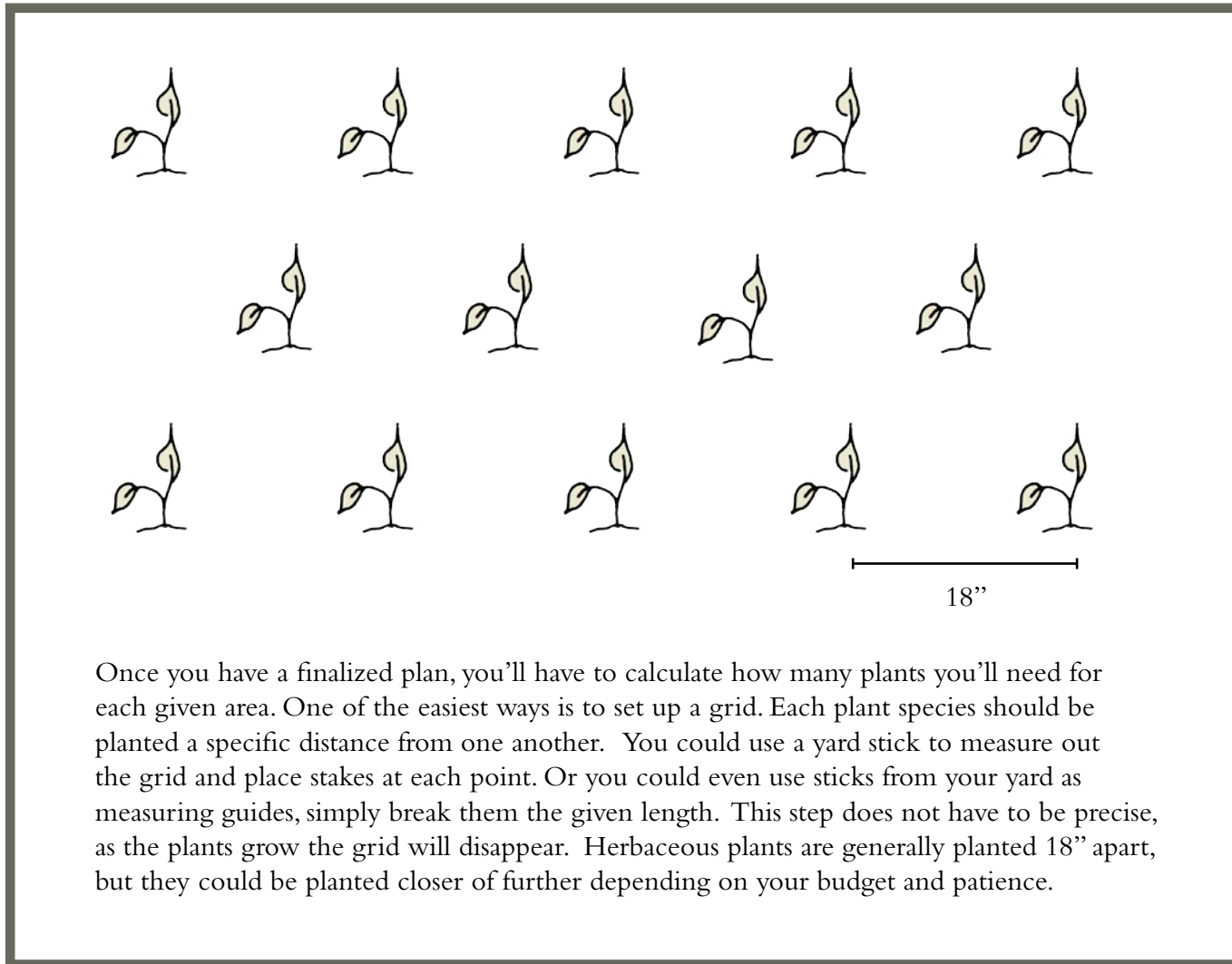

Once you have a finalized plan, you'll have to calculate how many plants you'll need for each given area. One of the easiest ways is to set up a grid. Each plant species should be planted a specific distance from one another. You could use a yard stick to measure out the grid and place stakes at each point. Or you could even use sticks from your yard as measuring guides, simply break them the given length. This step does not have to be precise, as the plants grow the grid will disappear. Herbaceous plants are generally planted 18" apart, but they could be planted closer or further depending on your budget and patience.